

## Schottky Barrier Diode

### Features

- Moisture sensitivity level 1
- Reverse voltage: 40V
- Average forward current : 200mA

### Application

- Signal switching
- High frequency rectifier

### Mechanical data

- **Package:** SOT-23
- **Terminals:** Tin plated leads, solderable per J-STD-002 and JESD22-B102

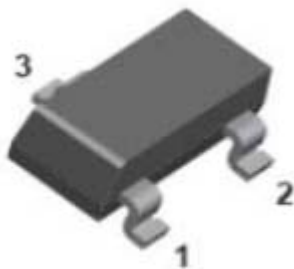
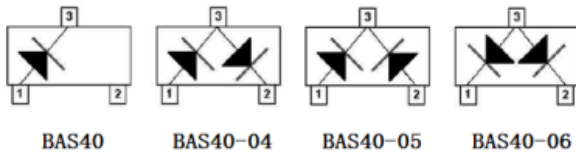

### ■ Maximum Ratings (T<sub>a</sub>=25°C Unless otherwise specified)

Parameter	Symbol	Unit	Value	
			Part	Value
Device marking code			BAS40WT	43
			BAS40WT -04	44
			BAS40WT -05	45
			BAS40WT -06	46
Repetitive peak reverse voltage	V <sub>RRM</sub>	V	40	
Forward current, per leg	I <sub>F</sub>	mA	200	
Non-repetitive surge peak forward current @ t=8.3ms half-sine wave	I <sub>FSM</sub>	A	0.6	
Non-repetitive surge peak forward current @ t=1ms square wave			2	
Power dissipation	P <sub>D</sub>	mW	200	
Junction temperature	T <sub>J</sub>	°C	-55 to +125	
Storage temperature	T <sub>STG</sub>	°C	-55 to +125	



# BAS40WT THRU BAS40WT-06

RoHS  
COMPLIANT

## ■ Electrical Characteristics (T<sub>a</sub>=25°C Unless otherwise specified)

Parameter	Symbol	UNIT	Conditions	Min	TYP	Max
Reverse voltage	V <sub>R</sub>	V	I <sub>R</sub> =10μA	40		
Forward voltage	V <sub>F1</sub>	mV	I <sub>F</sub> =1mA			380
	V <sub>F2</sub>	mV	I <sub>F</sub> =40mA			1000
Reverse leakage current	I <sub>R</sub>	nA	V <sub>R</sub> =30V			200
Junction capacitance	C <sub>j</sub>	pF	V <sub>R</sub> =0V, f=1MHz			5
Reverse recovery time	T <sub>rr</sub>	ns	I <sub>F</sub> =I <sub>R</sub> =5mA, I <sub>rr</sub> =0.1*I <sub>R</sub> , R <sub>L</sub> =100Ω			5

## ■ Thermal Characteristics

Parameter	Symbol	Unit	Value
Thermal resistance, junction-to-ambient	R <sub>θJ-A</sub> <sup>(1)</sup>	°C/W	500
Thermal resistance, junction-to-case	R <sub>θJ-C</sub> <sup>(1)</sup>	°C/W	400

### Note:

(1) Device mounted on PCB, single-sided copper, with standard footprint



## ■ Characteristics

**Fig 1:  $P_D$ - $T_a$  Curve**

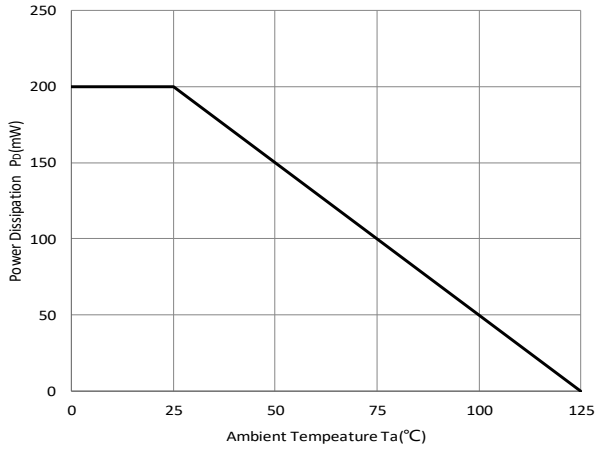

**Fig 2: Capacitance Capability**

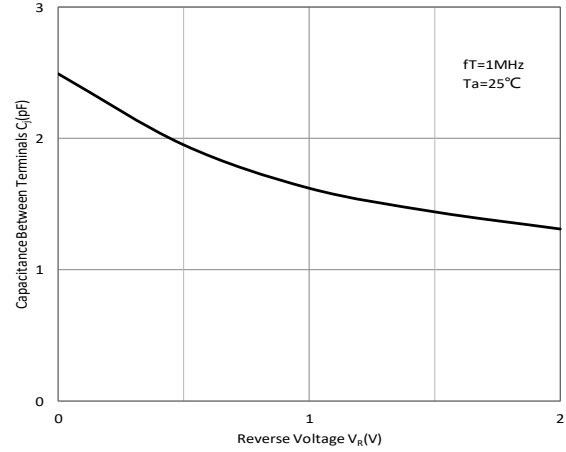

**Fig 3: Typical Forward Characteristics**

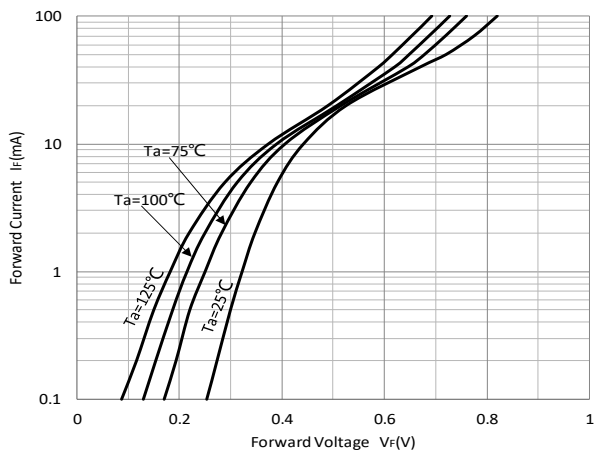

**Fig 4: Typical Reverse Characteristics**

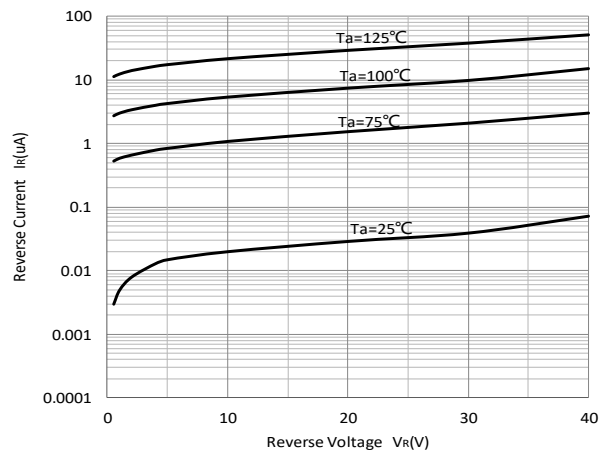



# BAS40WT THRU BAS40WT-06

RoHS  
COMPLIANT

## Ordering Information

Preferred P/N	Packing code	Unit weight(g)	Minimum package(pcs)	Inner box quantity(pcs)	Outer carton quantity (pcs)	Delivery mode
BAS40WT THRU BAS40WT-06	F2	Approximate 0.005	3000	30000	120000	7" reel

## Outline Dimensions

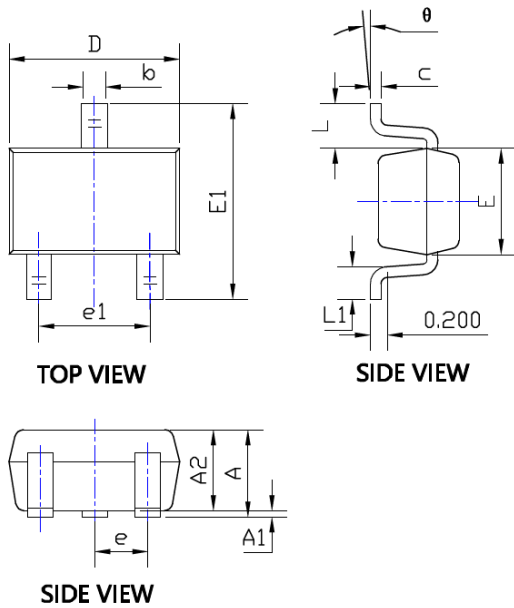

SYMBOL	DIMENSIONS			
	INCHES		Millimeter	
	MIN.	MAX.	MIN.	MAX.
A	0.035	0.043	0.900	1.100
A1	0.000	0.004	0.000	0.100
A2	0.035	0.039	0.900	1.000
b	0.006	0.016	0.150	0.400
c	0.004	0.010	0.100	0.250
D	0.071	0.087	1.800	2.200
E	0.045	0.053	1.150	1.350
E1	0.085	0.096	2.150	2.450
e	0.026 TYP		0.650 TYP	
e1	0.047	0.055	1.200	1.400
L	0.021 REF		0.525 REF	
L1	0.010	0.018	0.260	0.460
theta	0°	8°	0°	8°

## Suggested Pad Layout

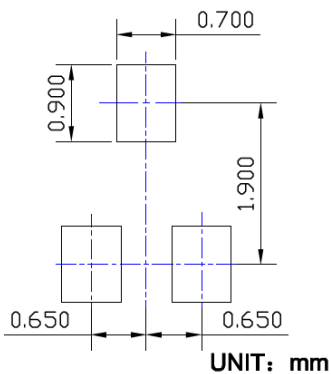



## Disclaimer

The information presented in this document is for reference only. Yangzhou Yangjie Electronic Technology Co., Ltd. reserves the right to make changes without notice for the specification of the products displayed herein to improve reliability, function, or design or otherwise.

The product listed herein is designed to be used with ordinary electronic equipment or devices, and not designed to be used with equipment or devices which require high level of reliability and the malfunction of which would directly endanger human life (such as medical instruments, transportation equipment, aerospace machinery, nuclear-reactor controllers, fuel controllers and other safety devices), Yangjie or anyone on its behalf, assumes no responsibility or liability for any damages resulting from such improper use of sale.

This publication supersedes & replaces all information previously supplied. For additional information, please visit our website [http:// www.21yangjie.com](http://www.21yangjie.com) , or consult your nearest Yangjie's sales office for further assistance.